

**KEY**

APPLICATION BOUNDARY	
INDICATIVE DC CABLE ALIGNMENT	
TEMPORARY WORKING AREA	
ANCILLARY AREA	
EXISTING ROAD MARKINGS	
PROPOSED ROAD MARKINGS	

**NOTES**

1. SIEMENS S93 NACELLE LOW LOADER HAS BEEN USED TO ILLUSTRATE SWEEP PATH ANALYSIS FOR CABLE DRUM VEHICLE.
2. RESTRICTED MOVEMENT JUNCTION. ACCESS FROM SOUTH ONLY.
3. REFER TO VKL-08-07-J-500-024 FOR LOCATION OF TEMPORARY CONSTRUCTION ACCESS.

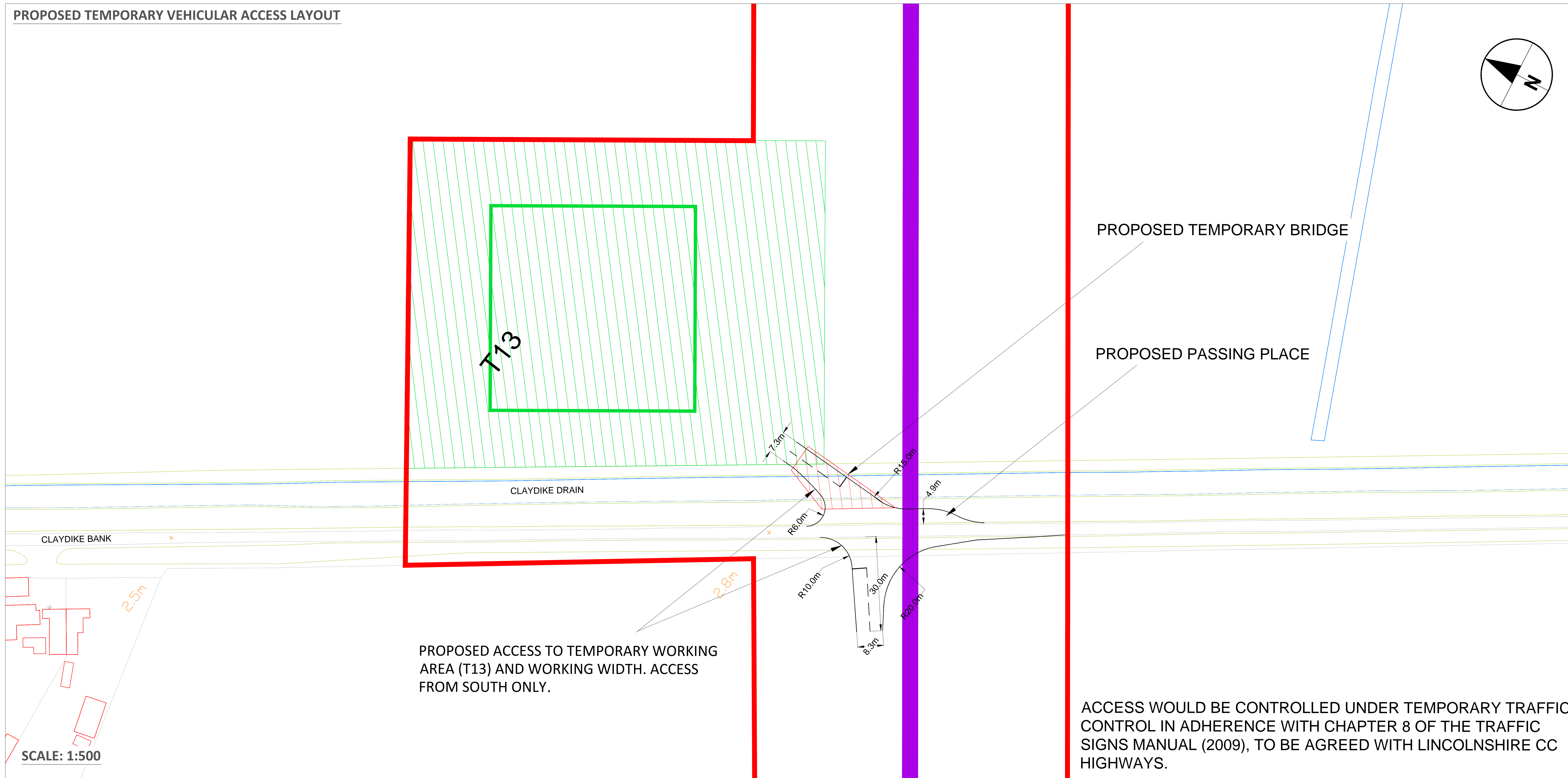

**TEMPORARY ACCESS LOCATION**

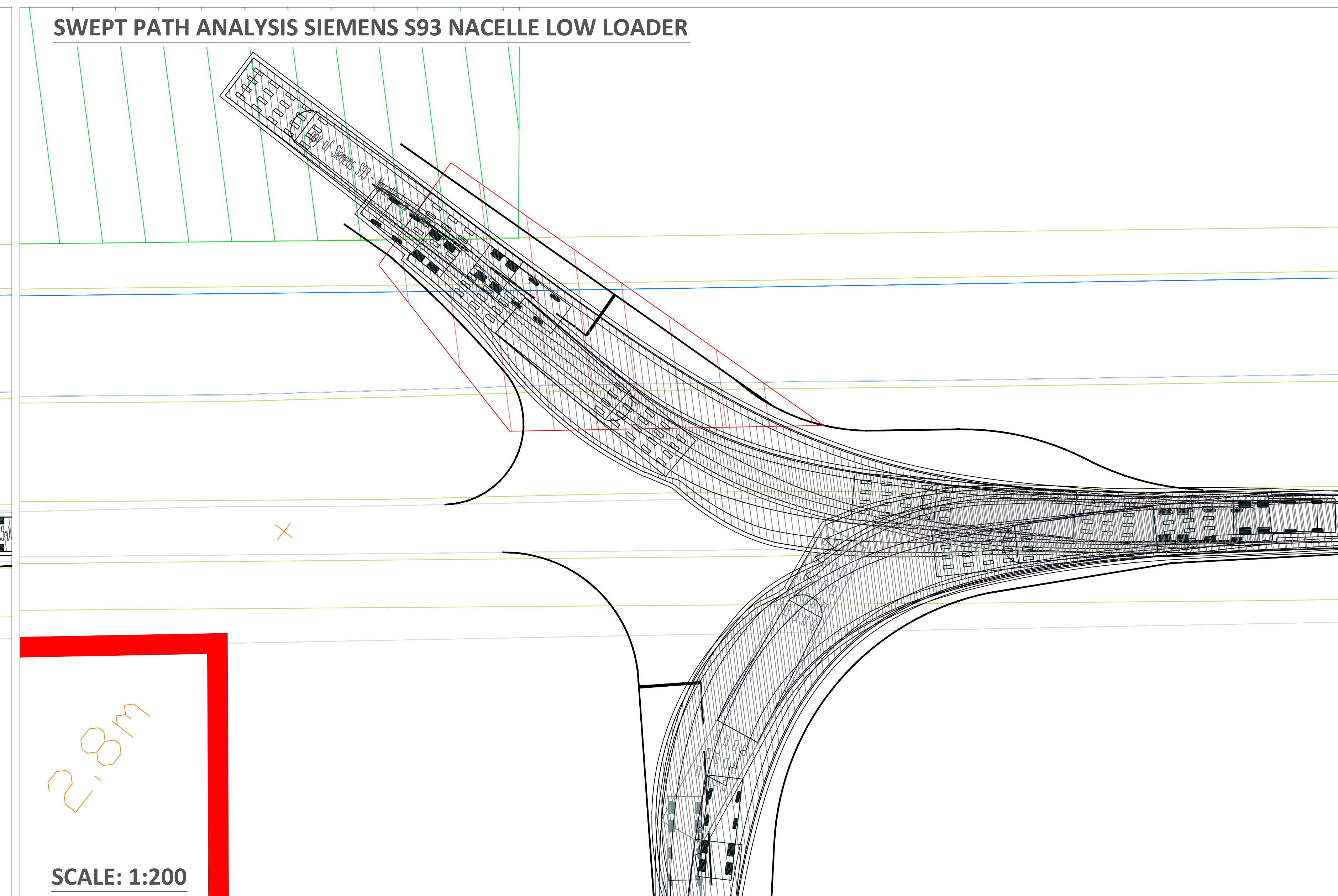
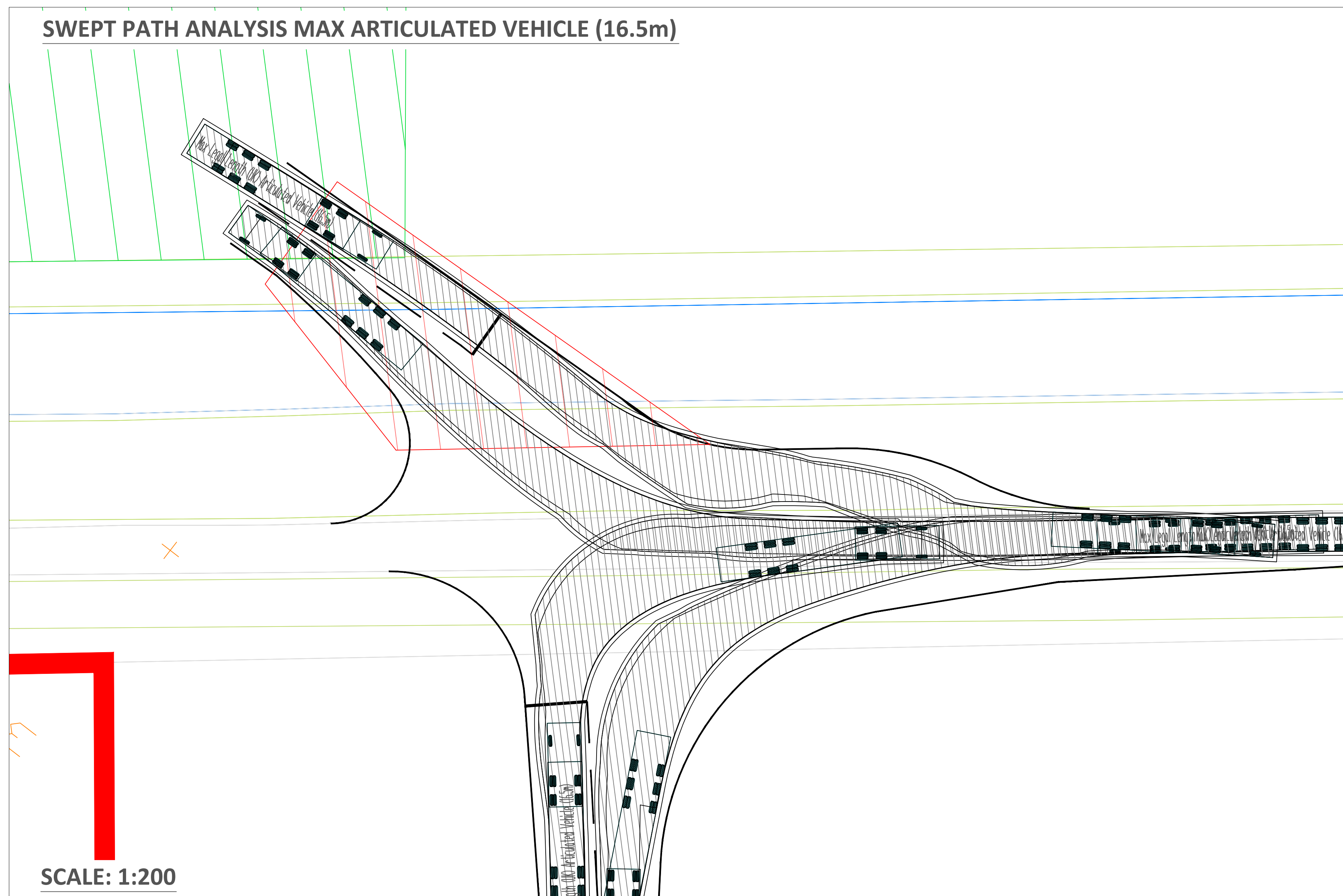
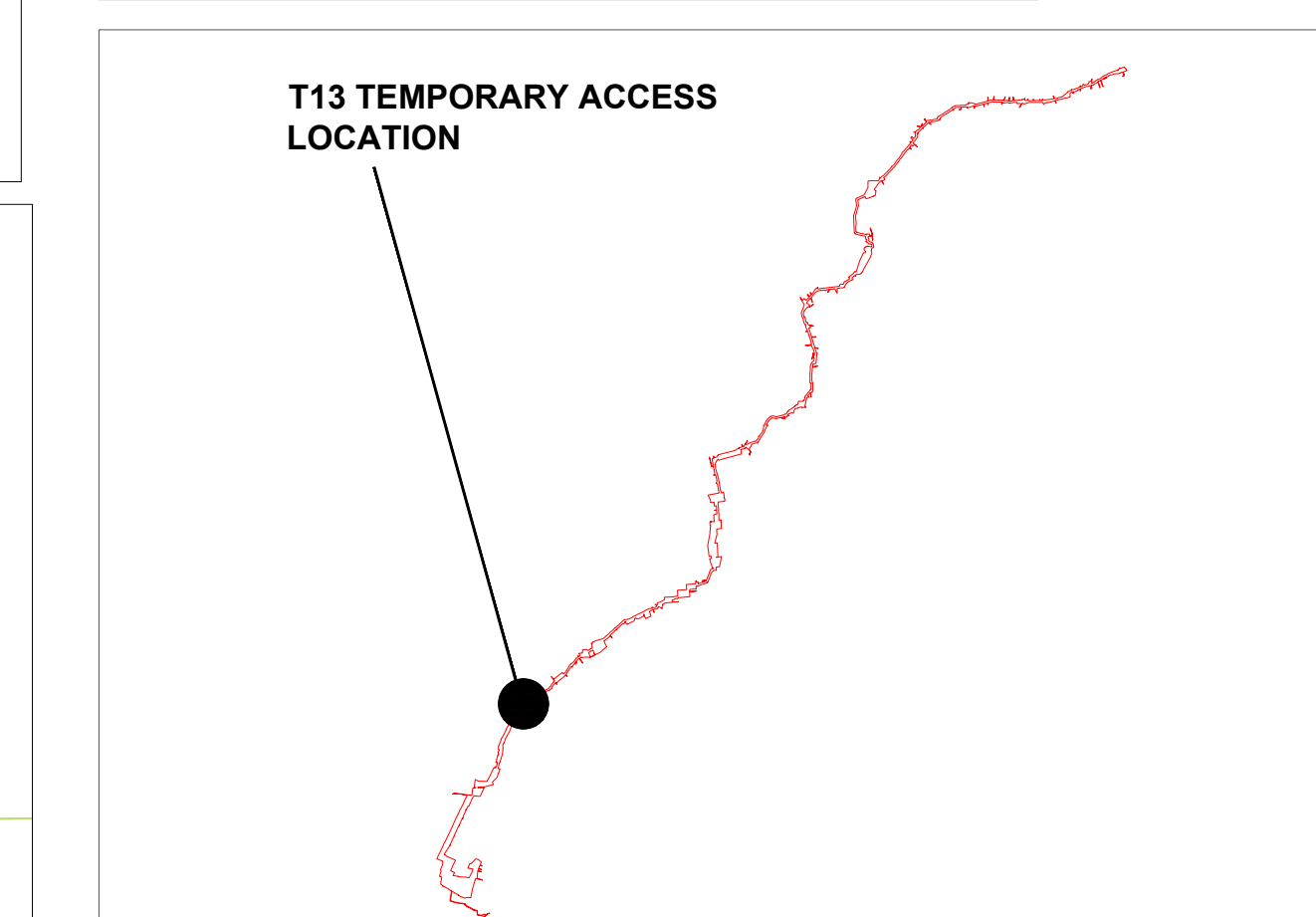

<b>FIGURE NO.</b>	<b>REV.</b>
VKL-08-07-J-500-021	0
<b>FIGURE TITLE</b>	
UK ONSHORE SCHEME TEMPORARY CONSTRUCTION ACCESS GENERAL ARRANGEMENT - CLAYDIKE BANK (T13)	
<b>SHEET NUMBER</b>	
1 OF 1	
<b>NOTES</b>	
Scale AS SHOWN @ A0	
<b>DATE</b>	
AUGUST 2017	